

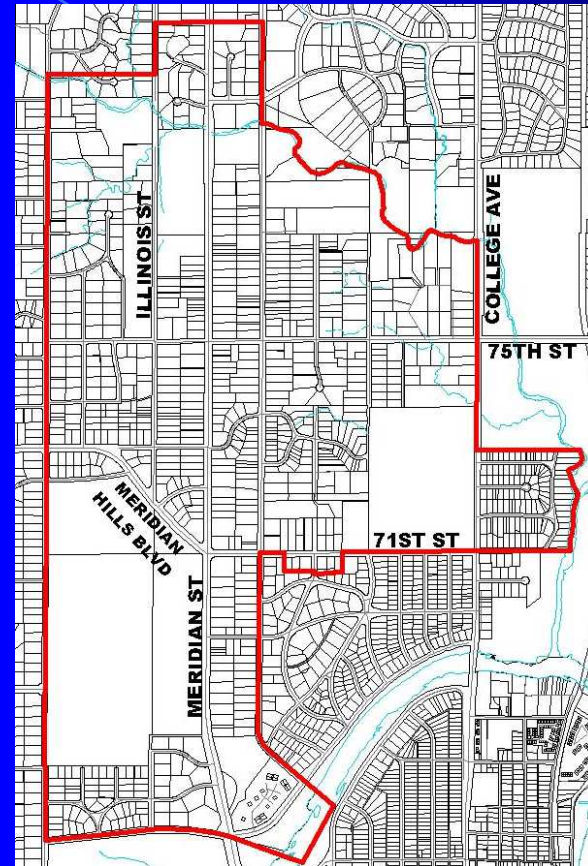

Town of Meridian Hills Stormwater Management Program Presentation



July 14, 2008





Presentation Topics



- Stormwater Program Background/General Information
- Importance/Purpose of the Stormwater Program
- Stormwater Program Issues and Questions
- Indianapolis Clean Stream Team Web Site
- Questions / Discussion



Stormwater Program Background/General Information

- Watershed Masterplan - 1994
The first coordinated look at stormwater control for Marion County
- NPDES Permit Number INS000001 – February 1, 1998
Federal water quality permit issued through and regulated by IDEM
- Preliminary Stormwater Masterplan - 1998
Compilation of known drainage problems county-wide and the estimated cost to correct them.
- Marion County Stormwater Management District & the Stormwater Utility - September 6, 2001, establishing:
 1. County-wide Stormwater Management District (excluding Speedway and Cumberland)
 2. County-Wide Stormwater Masterplan
 3. Stormwater Management District Billing and Collection

Stormwater Program

Background/General Information

Stormwater Management District

- The Marion County Stormwater Management District (MCSMD) was created to provide for the collection and disposal of stormwater in a manner that protects the public health, safety, and welfare.
- The Board of Public Works has exclusive jurisdiction over the collection and disposal of stormwater within the Marion County Stormwater Management District.
- The Department of Public Works manages the stormwater system within the MCSMD.
- The Marion County Stormwater Management Technical Advisory Committee (TAC) advises the Board of Public Works.

Stormwater Program Background/General Information

Countywide Stormwater Masterplan

- The Department of Public Works is responsible for providing the Board of Public Works and the City-County Council with a Countywide Stormwater Masterplan
- The Masterplan includes:
 - Stormwater infrastructure inventory
 - Stormwater conveyance system analyses
 - Responding to neighborhood and citizen input
 - Establishment of priorities for capital improvements
 - Integration of information into the Geographic Information System
 - Education and Public Outreach

Stormwater Program Background/General Information Summary

- District Created in 2001
- Public Works established as the department responsible for managing the stormwater system
- TAC established as entity to advise/provide recommendations to the Board
- Program Team members outside of DPW determined:
 - The Indianapolis Clean Stream Team
- Masterplan developed to identify project needs
- Stormwater utility billing and collection established as a means to fund projects - Initial fee - \$1.25/ERU, Current fee - \$2.25/ERU



Importance/Purpose of the Stormwater Program



Importance/Purpose of the Program

Increase Public Safety

Flooded neighborhoods:

- *Create hazardous conditions*
- *Impact health and welfare*
- *Damage or destroy infrastructure*
- *Impact sanitary sewer / septic systems*



Importance/Purpose of the Program

Improve Water Quality

Erosion from construction sites/general runoff impact water quality



Importance/Purpose of the Program

Avoidance of Economic Disruption and Losses

Flooded areas:

- *Impede access by residents and emergency services*
- *Inflict damage to property*



Importance/Purpose of the Program

Reduction of Human Suffering

Flooded neighborhoods impact the quality of life for residents



Importance/Purpose of the Program Summary

- Providing for the safe and efficient capture and conveyance of stormwater runoff :
 - Increases public safety
 - Improves water quality
 - Reduces damage to property and public infrastructure
 - Avoidance of economic disruption and losses

Meridian Hills

Questions and Issues

- **Identification of responsibilities - Public & Private Facilities**
- **System maintenance vs. Capital Improvement Program (CIP) Projects**
- **CIP project rating process**
- **Recommended maintenance of drainage systems & how to avoid problems**
- **What residents should do if they identify a problem**
- **Easements and Right-Of-Way**
- **DPW/Meridian Hills process to address drainage issues**
- **When and how residents apply for a drainage permit**
- **DPW points-of-contact**
- **Drainage Permits - When required/How to obtain**
- **Potential additional methods to fund stormwater improvements**

Identification of Responsibilities

MCSMD/DPW Organizational Structure & Functions

Policy & Planning Division - DPW Customer Service performs initial investigation of citizen complaints. The Customer Service representative initiates the Service Request (SR) to United Water for corrective action.

Operations Division - Water Services (WSR) is responsible for the operation and maintenance of MCSMD stormwater conveyance systems. WSR/United Water (UW) review the SR, determine scope of correction, estimated cost and priority. WSR issues any required Work Order(s)

Engineering Division - Plans, develops and implements the Capital Improvement Program. Serves as the Technical Staff for the Technical Advisory Committee.

Identification of Responsibilities

MCSMD/DPW is responsible for:

Storm water systems integral with public streets, roads and highways and contained within the public right-of-way, excluding driveway culverts and privately enclosed roadside ditches.

Class I storm drain systems contained within easements required by City of Indianapolis standards and specifications.

All other stormwater and flood control facilities under the direct ownership and/or control of the District.

Identification of Responsibilities

Property Owners are responsible for:

Stormwater facilities on private property including drainage systems that receive and carry runoff from publicly owned/operated stormwater conveyance systems,

Driveway culverts, pipes where ditches were enclosed by property owners, and

Ordinary maintenance of roadside ditches, such as removing vegetation, debris and built-up sediment to ensure the system functions properly.

Examples of Maintenance Responsibilities



Public Responsibility

Examples of Maintenance Responsibilities



Public Responsibility

Examples of Maintenance Responsibilities



**Property Owner
Responsibility**



Examples of Maintenance Responsibilities



Property Owner Responsibility

Stormwater System Maintenance Operations

DPW Operations performs:

Minor capital maintenance (MCM) work, such as ditch reconstruction and culvert pipe replacement,

Minor capital improvement (MCI) work such as the installation of storm inlets and short runs of storm pipe, and

Maintenance of flood control gates and pipe closures.

MCM, MCI & other maintenance work limitations:

The cost of the project cannot exceed \$75,000,

Maintenance solution cannot be beyond DPW Operations/United Water's capability to perform,

Funds are allocated by the City County Council through the annual budget and cannot be augmented unless by Fiscal Ordinance, and

Funding sufficient only to address Priority 1 and most Priority 2 work.

Capital Improvement Program (CIP) Stormwater Projects

CIP Stormwater Projects:

Must primarily benefit Public Infrastructure, Health, and or Safety.
Any derived private benefit must be incidental to the public benefit,

Exceed the cost cap and/or capability of DPW Operations/United Water to perform,

Are planned as a progressive 5-year program,

Are developed through a comprehensive planning and study process, based primarily on the Initial Stormwater Masterplan and the determined Initial Priority Rating (IPR),

Must be publicly bid, and

Must provide a cost effective and maintainable solution to address the project need.

Capital Improvement Program Initial Priority Rating (IPR)

Importance of the IPR:

Provides a systematic, uniform approach to evaluate all problem areas/potential projects equally,

Potential projects are ranked from highest to lowest priority for implementation - a higher IPR number represents a higher priority within the Stormwater Capital Improvement Program. Projects with higher IPRs will more than likely be accomplished first.

Aids in identifying multiple-problem locations within an area.

Capital Improvement Program Initial Priority Rating (IPR)

The IPR addresses the following areas:

- The street/area classification and the level of hazard to the public
- Frequency of the flooding & extent of potential street deterioration
- The use/type of the affected properties
- The number of properties affected
- Extent of flooding or erosion
- Water quality impacts/improvements
- Potential improvement in quality of life
- Cost-sharing willingness of property owners in the affected area

Capital Improvement Program Initial Priority Rating (IPR)

City of Indianapolis Marion County Stormwater Management District		Dept of Engineering Stormwater Need Evaluation Sheet						
Street Address: 7100 Williams Creek Drive (Approximate)		Site #: _____						
Nearest Intersection: North College Avenue & East 71st Street		Township: Washington						
Rating By: MCSMD		Date: 6/21/05		Council District: 3				
Revision Date: _____		Revision Date: _____						
INSTRUCTIONS: Fill in only 1 "X" per Group Rating								
CONVEYANCE CLASSIFICATION	STREET CLASSIFICATION	HYDRAULIC CONVEYANCE FEATURE			Rating			
		Open Channel	Bridge	Storm System				
	Thoroughfare	4	3	1	0			
	Collector	3			0			
	Local	2		X	0			
STREET FLOODING	STREET CLASSIFICATION	STREET FLOODING OCCURRENCES				Rating		
		Every Rain	Once/2 Yr	Once/10 Yr	Once/25 Yr			
	Thoroughfare	8	4	2	1	0		
	Collector	4				0		
	Local	2	X			6		
PAVEMENT DETERIORATION	STREET CLASSIFICATION	TOTAL PAVEMENT DETERIORATION WITHIN					Rating	
		1 year	2 years	3 years	10 years	>10 Years		
	Thoroughfare	4	5	4	3	2	1	0
	Collector	3						0
	Local	2		X				6
FLOODED "IN"	PROPERTY CLASSIFICATION	FLOODED "IN" OCCURRENCES				Rating		
		Every Rain	Once/2 Yr	Once/10 Yr	Once/25 Yr			
	Homes	8	6	4	2	16		
	Businesses	4			X	0		
	Parking Lots	2				0		
	Yards / Fields	1				0		
FLOODING AND/OR EROSION IMPACTS	PROPERTY CLASSIFICATION	NUMBER OF FEATURES AFFECTED					Rating	
		1 - 10	11 - 25	26 - 50	> 50	> 50		
	Homes (septic)	8	2	4	6	8	0	
	Homes (sanit)	6	X				12	
	Businesses	4					0	
	Parking Lots	2					0	
	Yards / Fields	1					0	
EXTENT OF FLOODING AND/OR EROSION	PROPERTY CLASSIFICATION	LINEAL FEET OF SEVERE FLOODING AND/OR EROSION				Rating		
		10 - 100	101 - 250	251 - 500	> 500			
	City Property	8	1	2	4	8	0	
	Regulated Drain	4					0	
	On Private Prop.	2					0	
WATER QUALITY	(Improvement in water quality, scale of 1-10)	In Barrett Law Area			Rating			
		Benefit to CSO	Area	1				
	Improvement Rating	10	3	2	1	0		
WATER QUALITY FOCUS	(Improvement in water quality, scale of 1-10)	TSS			Rating			
		E. coli	Other	1				
	Improvement Rating*	10	X		30			
*When considering the degree of improvement, also take into account the frequency that the parameter of concern exceeds the standard level.								
QUALITY OF LIFE	(Improvement in quality of life use scale of 1-10)	QUALITY OF LIFE			Rating			
		Extremely Poor Conditions	Very Poor	Poor				
	Improvement Rating	5	3	2	1	5		
				X				
PUBLIC INVOLVE	COST SHARE	COST SHARE			Rating			
		> 75%	26 - 75%	0 - 25%				
	% by Developer/Owner	10	3	2	1	0		
PRIORITY RATING					47			

Form Revised May 15, 2003

IPR 71st & Williams Creek Drive

City of Indianapolis Marion County Stormwater Management District		Dept of Engineering Stormwater Need Evaluation Sheet						
Street Address: 7801 N. College Ave. (Approximate)		Site #: 29						
Nearest Intersection: North College Avenue & East 78th Street		Township: Washington						
Rating By: MCSMD		Date: 6/6/03		Council District: 3				
Revision Date: _____		Revision Date: _____						
INSTRUCTIONS: Fill in only 1 "X" per Group Rating								
CONVEYANCE CLASSIFICATION	STREET CLASSIFICATION	HYDRAULIC CONVEYANCE FEATURE			Rating			
		Open Channel	Bridge	Storm System				
	Thoroughfare	4	3	1	4			
	Collector	3		X	0			
	Local	2			0			
STREET FLOODING	STREET CLASSIFICATION	STREET FLOODING OCCURRENCES				Rating		
		Every Rain	Once/2 Yr	Once/10 Yr	Once/25 Yr			
	Thoroughfare	8	4	2	1	32		
	Collector	4	X			0		
	Local	2				0		
PAVEMENT DETERIORATION	STREET CLASSIFICATION	TOTAL PAVEMENT DETERIORATION WITHIN					Rating	
		1 year	2 years	3 years	10 years	>10 Years		
	Thoroughfare	4	5	4	3	2	1	0
	Collector	3						0
	Local	2				X		0
FLOODED "IN"	PROPERTY CLASSIFICATION	FLOODED "IN" OCCURRENCES				Rating		
		Every Rain	Once/2 Yr	Once/10 Yr	Once/25 Yr			
	Homes	8	6	4	2	16		
	Businesses	4			X	0		
	Parking Lots	2				0		
	Yards / Fields	1				0		
FLOODING AND/OR EROSION IMPACTS	PROPERTY CLASSIFICATION	NUMBER OF FEATURES AFFECTED					Rating	
		1 - 10	11 - 25	26 - 50	> 50	> 50		
	Homes (septic)	8	2	4	6	8	0	
	Homes (sanit)	6	X				24	
	Businesses	4					0	
	Parking Lots	2					0	
	Yards / Fields	1					0	
EXTENT OF FLOODING AND/OR EROSION	PROPERTY CLASSIFICATION	LINEAL FEET OF SEVERE FLOODING AND/OR EROSION				Rating		
		10 - 100	101 - 250	251 - 500	> 500			
	City Property	8	1	2	4	8	16	
	Regulated Drain	4					0	
	On Private Prop.	2					0	
WATER QUALITY	(Improvement in water quality, scale of 1-10)	In Barrett Law Area			Rating			
		Benefit to CSO	Area	1				
	Improvement Rating	10	3	2	1	0		
WATER QUALITY FOCUS	(Improvement in water quality, scale of 1-10)	TSS			Rating			
		E. coli	Other	1				
	Improvement Rating*	10	X		30			
*When considering the degree of improvement, also take into account the frequency that the parameter of concern exceeds the standard level.								
QUALITY OF LIFE	(Improvement in quality of life use scale of 1-10)	QUALITY OF LIFE			Rating			
		Extremely Poor Conditions	Very Poor	Poor				
	Improvement Rating	5	3	2	1	5		
				X				
PUBLIC INVOLVE	COST SHARE	COST SHARE			Rating			
		> 75%	26 - 75%	0 - 25%				
	% by Developer/Owner	10	3	2	1	0		
PRIORITY RATING					137			

Form Revised May 15, 2003

IPR 78th & College

Recommended Maintenance of Ditches, Swales and Drainage Facilities



Remove leaves and debris from ditches, culvert pipe openings and storm inlets before drainage is blocked. Periodically removing small amounts of debris is a more manageable process.

Avoiding Creating Drainage Problem



Design & construct systems per current standards

Ensure site improvements do not block or restrict existing drainage ways

Ensure drainage ways and pipes are maintained and functioning properly

What Residents Should Do If They Identify a Problem

Stormwater system and drainage problems should be reported to the Mayor's Action Center (MAC)

Requests for service may be made by calling:

327-4622 (327-4MAC)

Or on the Web at:

www.indygov.org/mac



Always remember to ask for and receive your Tracking Number !

Public Right-of-Way & Easements

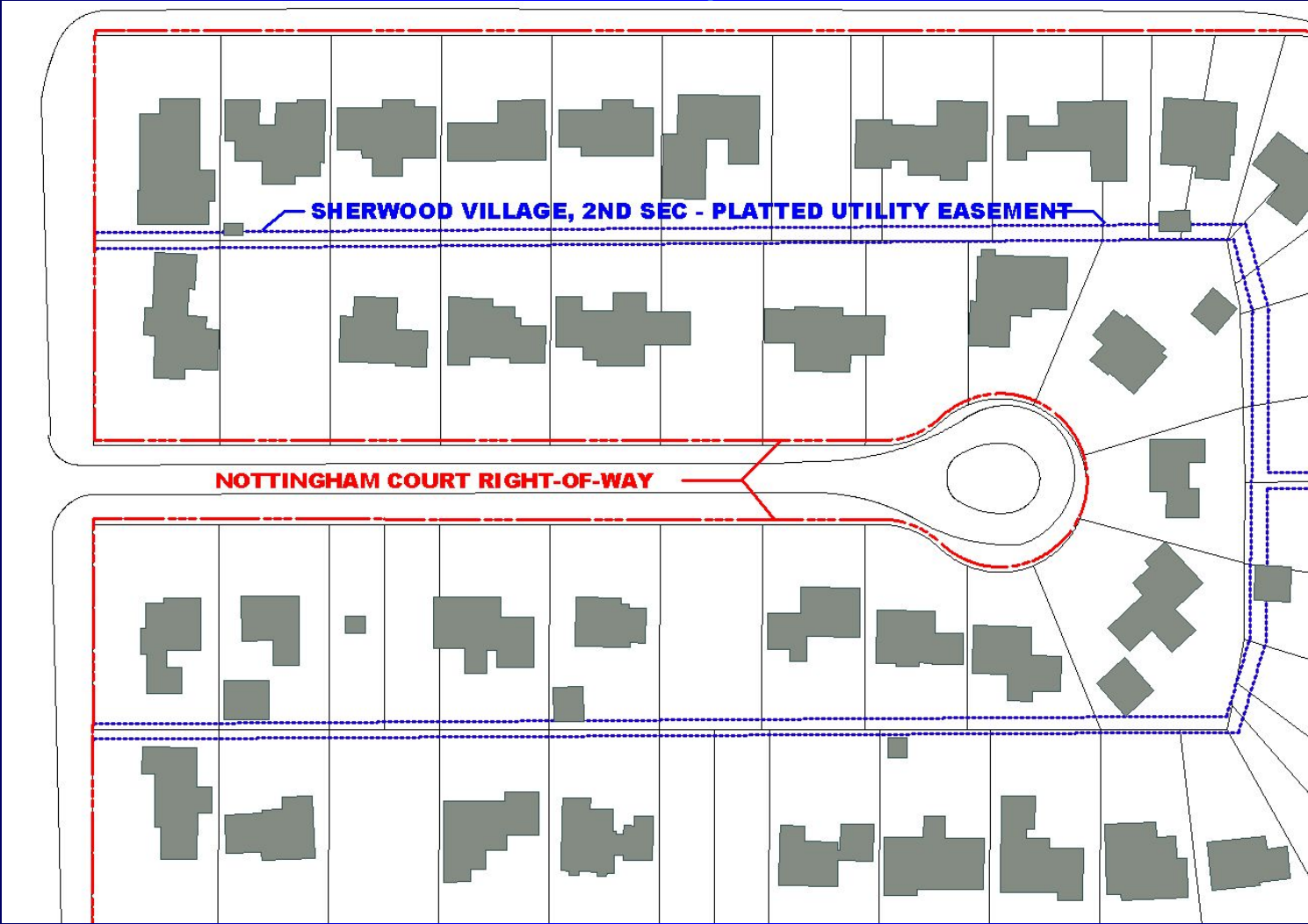

Public Right-of-Way

Public Right-of-Way:

Generally contains public roads & streets and related stormwater conveyance systems,

Owned/operated by the municipality,

May be established by subdivision platting,

Acquired through dedication by property owner as part of development, or

Acquired as part of a Capital Improvement Project.



As noted previously, the District maintains municipally owned and operated stormwater systems within the public right-of-way.

Easements

Easements:

Like public right-of-way, may be acquired through platting, dedication or capital project land acquisition process.

Establish locations within a development or building site for the location and construction of drainage facilities.

Allow the municipality to the reconstruct or maintain drainage systems if necessary to protect public infrastructure.

Should not be obstructed by buildings, fences or other improvements.

Easements

Easements:

Allow property owner to retain ownership of land,

Do not relieve the property owner of the responsibility to maintain the property's drainage facilities, and

Do not create a duty for the municipality to maintain drainage facilities within the easement area, but only a right to do so if necessary.

Preferred Process to Address Drainage Issues

Initial citizen requests for service:

Request is made to the MAC either by phone or on-line.

Existing Service Requests and/or Work Orders:

Meridian Hills Town Engineer communicates and coordinates with DPW Water Services staff by phone, email and/or personal meeting as necessary.

CIP Project planning and development:

Meridian Hills Town Engineer communicates and coordinates with DPW Engineering staff by phone, email and/or personal meeting as necessary.

When and How Residents Apply for Drainage Permits

A drainage permit is required when on-site or off-site land altering activities:

Change the land contours, or

Increase the runoff rate or volume, or

Change elevation, or

Decrease the rate at which water is absorbed, or

Change a drainage pattern, or

Create or change a stormwater facility, or

Involve the construction, enlargement, or location of any building/structure on a permanent foundation, or

Increase the delivery of point or non-point source pollution to streams, or

Create an impoundment.

When and How Residents Apply for Drainage Permits

**Application for a Drainage Permit may be
made at:**

**Division of Compliance
Department of Metropolitan Development
1200 Madison Avenue, Suite 100
Indianapolis, IN 46225
327-8700**

Lobby Hours of Operation

Monday, Tuesday, Thursday - 8:00 AM to 5:00PM

Wednesday - Noon to 5:00 PM

Friday - 9:00 AM to 5:00 PM

DPW/DMD Points-of-Contact

General information and DPW Public Affairs

327-4000

M - F, 8:00 AM to 5:00 PM

Complaints regarding drainage problems, sewer backups, missed trash pick-up, traffic signals, chuckholes, curbs/sidewalks and other municipal facilities:

The Mayor's Action Center

By phone: 327-4622 (327-4MAC)

By email: www.indygov.org/mac

Neighborhood/Community Issues

Catherine A. Moore

Mayor's Neighborhood Liaison

327-5380 or cmoore2@indygov.org

Special Assessment Districts for Stormwater Funding

By statute, the Marion County Stormwater Management District is prohibited from establishing secondary special funding districts for stormwater improvements.

However:

Preliminary analyses by the Department of Public Works and the City of Indianapolis Office of Corporation Counsel, indicates that as legally constituted municipalities, incorporated towns may be able to establish a stormwater assessment district within the town's municipal boundaries.

NOTE: Further statutory study is required on this topic. The MCSMD recommends that the Town of Meridian Hills investigate this concept further.



Clean Stream Team Website



Home - Microsoft Internet Explorer

File Edit View Favorites Tools Help

Back Forward Stop Refresh Home Search Favorites Media Mail Print W

Address <http://www.indygov.org/eGov/City/DPW/Environment/CleanStream/home.htm> Go Links

Search | Site Map | Contact Us **IndyGov**

DPW Department of Public Works, City of Indianapolis
Clean Stream Team

Home The Problems The Solutions Documents Projects Financing How You Can Help

Search

Entire Site
 Clean Streams Only

Indianapolis Clean Stream Team
151 N. Delaware St.
Suite 900
Indianapolis, IN 46204
Phone: (317) 327-8720
Fax: (317) 327-8699

The Indianapolis Clean Stream Team's mission is to restore area streams and engage public participation in the process. The Clean Stream Team oversees projects to prevent raw sewage overflows into our waterways, eliminate failing septic systems, and improve flood control and drainage. The team includes staff from the Department of Public Works and many private sector partners.

INDIANAPOLIS CLEAN STREAM TEAM

Home > Local Government > City > Public Works > Protecting the Environment > Indianapolis Clean Stream Team

Welcome to the Indianapolis Clean Stream Team

Clean Stream Team News:

City-County Council Approves Mayor's Plan to make Indianapolis neighborhoods cleaner, healthier

[Click here](#) to view the Fall Creek/White River Tunnel Project PowerPoint.

Contact Us

- [Drainage issue](#)
- [Sewer issue](#)
- [Septic issue](#)
- [Project Information](#)

Calendar

- [Upcoming events](#)

News You Can Use

- [Sewer Overflow Alerts](#)
- [Mailing List Sign-Up](#)
- [Press Releases](#)
- [Stream Line Newsletters](#)
- [Q & A](#)

JOIN THE TEAM

correct connect
Connect downspouts and sump pumps correctly to public sewers

IMPORTANT INFORMATION FOR INDIANAPOLIS RESIDENTS ABOUT FATS, OILS AND GREASE IN OUR SEWERS

[Click here to learn more about the city's new sewer connection fee](#)

Home | Search | Services | Mayor | Council | City | County | Courts

Done Local intranet



<http://www.indygov.org/eGov/City/DPW/Environment/CleanStream/home.htm>





Questions & Further Discussion

